

FORM NO 1.

Courses and Distances  
 Begin at White Oak and  
 by James Scotts Land  
 570 E 11 to White Oak  
 and by the same  
 N 83 E 64 White Walnut  
 and by Vacant Ridge  
 530 N 180 White by  
 Vacant Land  
 N 16 W 17 White Oak  
 by same  
 N 18 W 26 30 Oak by  
 same  
 N 37 W 46 Beech on  
 Tuscarora down same  
 N 36 E 46  
 N 51 E 34  
 N 11 E 16 to Begn  
 96

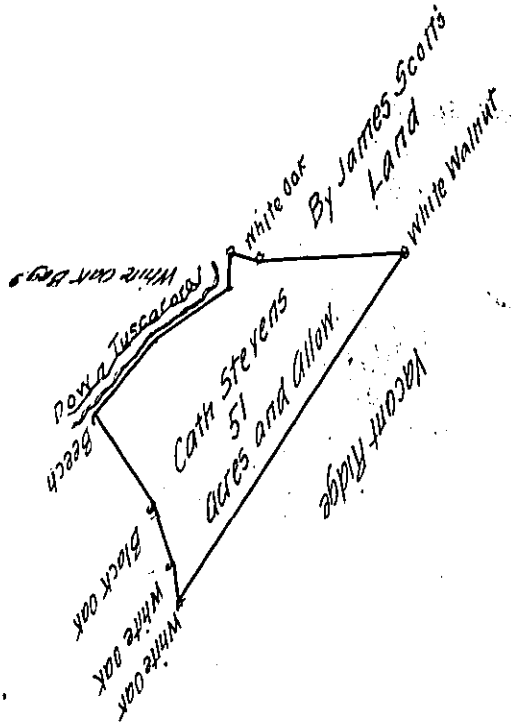

The Draught of a Tract of Land called \_\_\_\_\_  
 situate on Tuscarora Creek in the County of Cumberland containing fifty one Acres and  
 Allowance proportionate to Six Acres Percent for Roads Survey'd the 23<sup>d</sup> day of October  
 Anno Dom: 1767 in Pursuance of an Order of Survey to Catherine Stevens Bearing Date  
 at Philad<sup>a</sup> the 15<sup>th</sup> day of June Anno Dom: 1767 N<sup>o</sup> 3855  
 To John Lukens Esq 56. } W<sup>m</sup> Maclay D.S.  
 of Pennsylvania. }

IN TESTIMONY that the above is a copy of the original remaining on file in  
 the Department of Internal Affairs of Pennsylvania, made  
 conformably to an Act of Assembly approved the 16th day of  
 February, 1833, I have hereunto set my Hand and caused  
 the Seal of said Department to be affixed at Harrisburg,  
 this thirteenth day of March 1907

*Isaac R. Brown*  
 Secretary of Internal Affairs.